

Big Safety
 New York
 800.962.7962

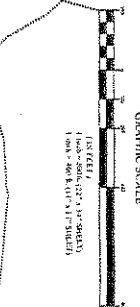
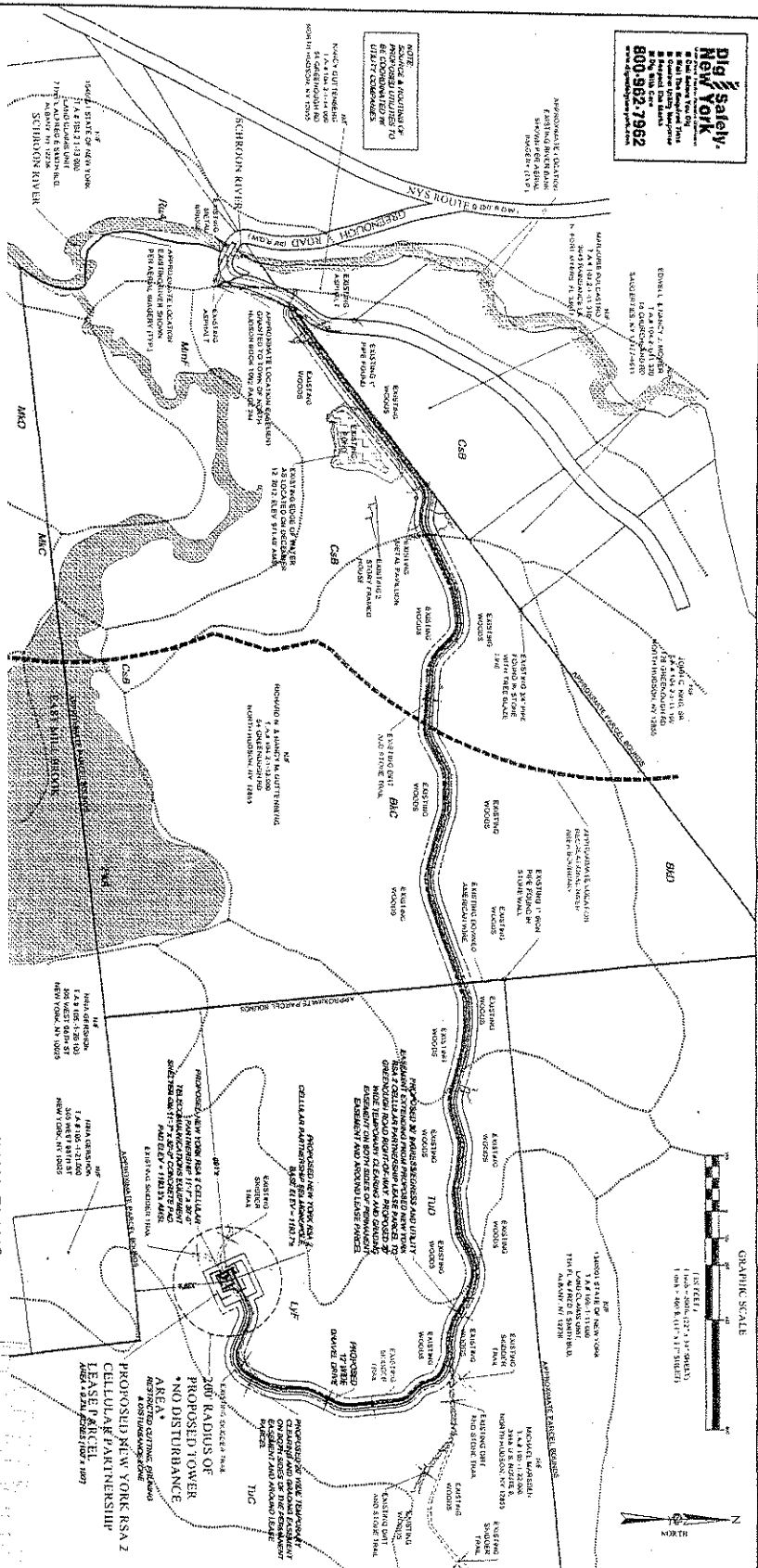

NORTH ORIENTATION

1. NORTH ORIENTATION OF THE SITE PLAN IS INDICATED BY THE NORTH ARROW.

2. THE NORTH ORIENTATION OF THE SITE PLAN IS INDICATED BY THE NORTH ARROW.

SITE PLAN

1. THE SITE PLAN IS A PLAN OF THE PROPOSED TOWER SITES AND RELATED INFRASTRUCTURE.

2. THE SITE PLAN IS A PLAN OF THE PROPOSED TOWER SITES AND RELATED INFRASTRUCTURE.

LEGEND

1. PROPOSED TOWER SITES

2. PROPOSED TOWER SITES

3. PROPOSED TOWER SITES

GENERAL NOTES

1. THE SITE PLAN IS A PLAN OF THE PROPOSED TOWER SITES AND RELATED INFRASTRUCTURE.

2. THE SITE PLAN IS A PLAN OF THE PROPOSED TOWER SITES AND RELATED INFRASTRUCTURE.

MAP REFERENCES

1. THE SITE PLAN IS A PLAN OF THE PROPOSED TOWER SITES AND RELATED INFRASTRUCTURE.

2. THE SITE PLAN IS A PLAN OF THE PROPOSED TOWER SITES AND RELATED INFRASTRUCTURE.

DISTANCES

1. THE SITE PLAN IS A PLAN OF THE PROPOSED TOWER SITES AND RELATED INFRASTRUCTURE.

2. THE SITE PLAN IS A PLAN OF THE PROPOSED TOWER SITES AND RELATED INFRASTRUCTURE.

ADIRONDACK PARK AGENCY

DATE: May 21, 2017

FINAL PLANS

SITE PLAN - OWNER APPROVAL

UNDERWOOD II PROJECT #201093115

LOCATION CODE: 271628

COUNTY OF ESSEX

STATE OF NEW YORK

OVERALL SITE PLAN

4137.01

CA100

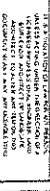

VERIZON Wireless

COSTICH Engineering

GOVERNMENT

STATE OF NEW YORK

COUNTY OF ESSEX

OWNER APPROVAL

UNDERWOOD II PROJECT #201093115

LOCATION CODE: 271628

OVERALL SITE PLAN

4137.01

CA100